

**Brief Specification: Flat Steel**

- 1.6mm Panels: Flat Panel
- Base Plates: Extended Slotted
- Top Plates: Extended Top Lift
- Jacklegs: -
- Lifting Points: Top Corner Only
- Forklift Tunnels: -
- Staircase Fixings: Fixing Bolts
- Link Frame: -
- Ceiling Height: 2400mm
- Insulation: See Table
- NB. Floor Panel

**External Finish: Mid-Sheen**

- Body: RAL 8015 'Brown'
- Comers: RAL 8015 'Brown'
- Plinth: RAL 8015 'Brown'
- Fascia: RAL 8015 'Brown'
- Windows & Door (External): Rosewood
- Windows & Door (Internal): White

Finishes are indicative. It is the client's responsibility to ensure these are correct



**Window: W01**

- uPVC double glazed PAS24 1.6W/m2.K
- Double Casement - Single Side Opener
- 1250 x 880h frame @ 1050mm affl
- Obscured K Glass
- Trickle vents
- Locks

**Window: W02**

- uPVC double glazed PAS24 1.6W/m2.K
- Double Casement - Double Side Opener
- 1500 x 1080h frame @ 850mm affl
- K glass
- Trickle vents
- Locks

**Door:**

- uPVC double glazed PAS24 1.6W/m2.K
- Double Casement - Double Side Opener
- To suit structural opening 920 x 2100h frame
- Key**
- Solid core doors pre finished in oak
- Latch: Mortice Latch
- BL: Bathroom Lock
- MCW: Mains Cold Water Inlet
- WO: Waste Outlet
- Waste & Water Protected By Steel Shroud

**Internal Finish**

- Wall Finish: Matt White Anti-Fungal Paint
- Ceiling Finish: Matt White Anti-Fungal Paint
- Floor Finish: Polysafe Wood FX PUR 3376 'Tropical Pine'
- Window Sills: White Laminated Bull Nose
- Internal Door Architrave: Grey (RAL 7046)
- 100mm Timber Skirting: Grey (RAL 7046)
- Worktop: 38mm Sq. Edge Oak Effect
- Howdens Base Units: Greenwich White Gloss
- Mirrored Cabinet: Gloss White (500 x 700 x 140mm)

- Tolerance:** ±2mm
- Timber Framing:** 70mm
- Prod. No.:** -
- Fleet No.:** -
- Stickers:** -
- I.D. Plate:** -
- Module Weight:** -
- Laden Weight:** -
- Max. Lift Weight:** -

**Electrical Key**

- Flush Single Phase Consumer Unit c/w Surge Protection @ 1.35m affl
- Appliance Inlet (Suitably Sized)
- 6W LED Circular Surface Mounted Slim Panel Downlight (IP20)
- Light Switch @ 1100mm affl
- Double Sockets @ 500mm affl  
USB - USB Outlets
- Double Sockets @ 1100mm affl  
USB - USB Outlets
- Telephone Socket @ 500mm affl
- Shaver Socket @ 1100mm affl
- Consort PLE-RF Panel Heater (Size Stated) c/w Onboard Controller
- Consort MRX1 Multizone Wireless Controller
- 9kW Aures Instantaneous Water Heater
- Extract Fan (Size Stated)  
T - Timer  
Linked to Lighting

Insulation			
Element	Type	Thickness	U-Value
Roof	K107	120mm	0.15W/m2/.K
Walls	K107	70mm	0.22W/m2/.K
Floor	K107	70mm	0.16W/m2/.K
	Cladding Matt 35	100mm	

**Notes**

Insulation is inline with the 2020 Technical Handbook (Scotland) Domestic as a baseline assumption. The client must seek guidance from their local planning department & building control. Cabins can be stacked two high only.

**Plumbing**

- Lamona Square Single Bowl S/S Kitchen Sink c/w Mixer Tap
- BTW WC c/w Concealed Cistern & Flush Plate
- Bristan Zing Thermostatic Bar Shower c/w Riser
- Bristan Cadet Mixer Tap (WHB)
- Lecico Atlas Sq. 46cm WHB c/w Bottle Trap
- 800 x 1000mm 4UPS Tray c/w Bi-Fold Door
- Plastic Pipework

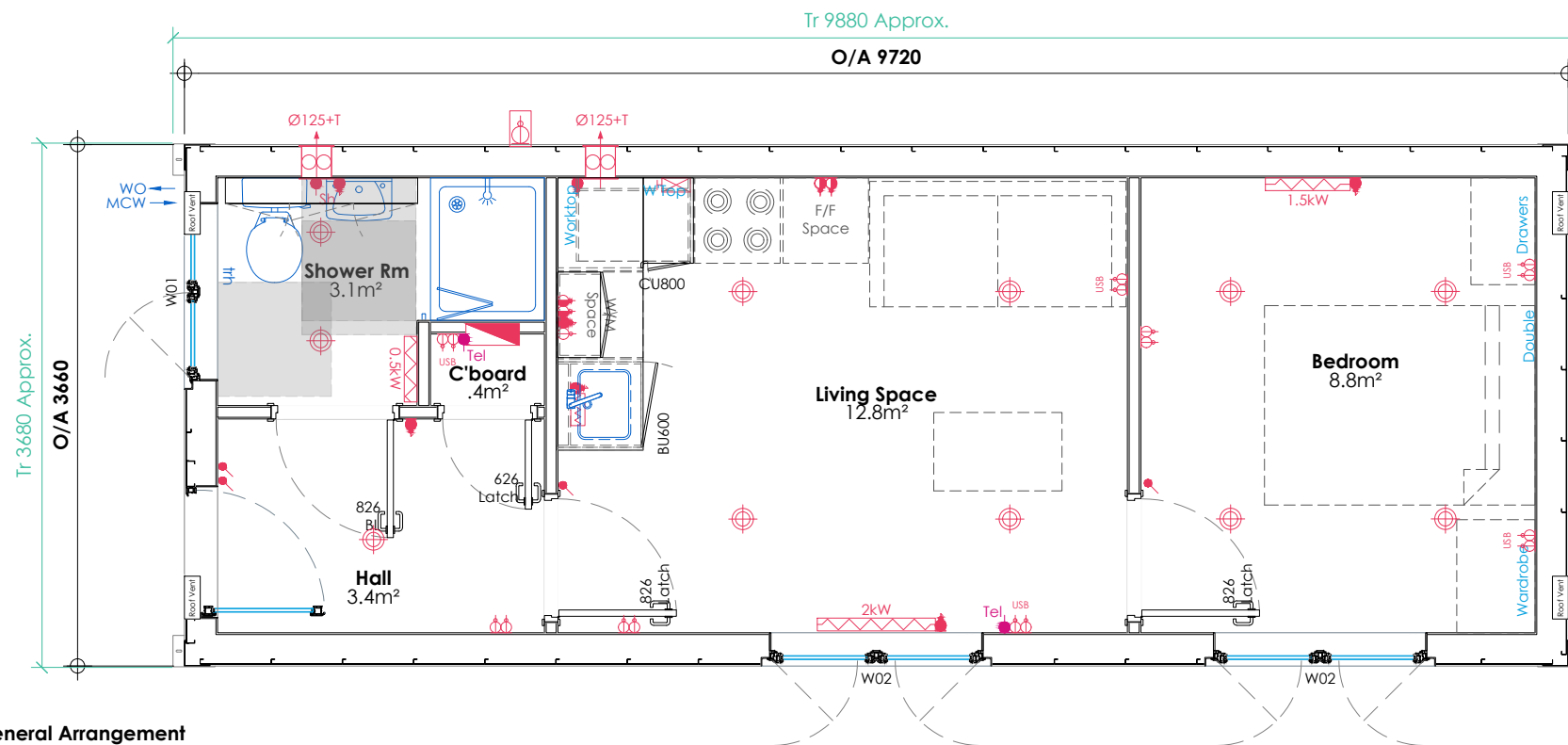

**00 General Arrangement**  
1:50

rev	description	by/chk	date
P03	Revised to client comments, layout changed to suit Domestic Technical Standards minimum space space requirements	ST/SF	14.03.22
P02	Revised to client comments	ST/SF	01.12.21
P01	First issue	ST/RC	15.11.21



client:

project:

**Residential Cabin**

title:

**General Arrangement**

date: 15.11.21  
design lead: ST  
project ref: 2122907  
checked: RC  
scale @ A3: As Shown

**PRELIMINARY**

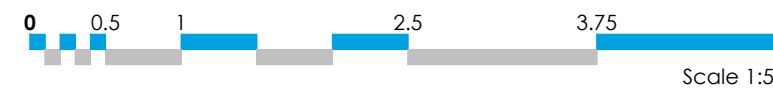

dwg ref: 100

rev: P03